

# AUTOMATIC INTERNAL CONNECTOR - TYPE CI

for easy and quick connecting of test objects (internal)

## Applications

Pneumatically controlled connector for easy and quick connecting of test pieces for proof testing, leak testing and leak detection.

## Mode of Operation

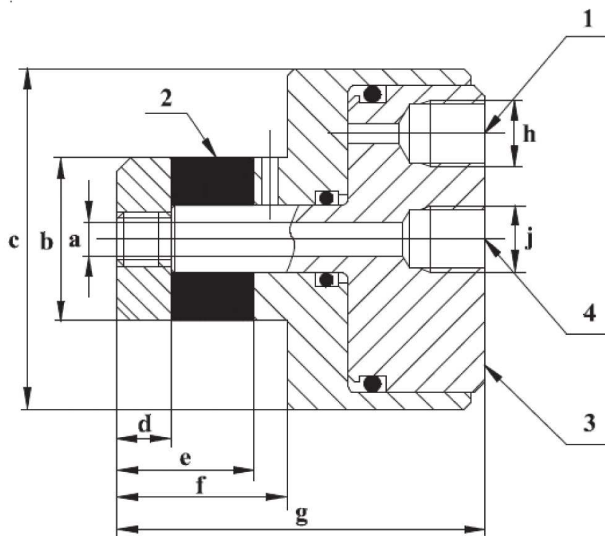

- The connector is positioned manually or automatically.
- Compressed air is supplied to port 1 from a manually or automatically controlled valve or automatically from a leak testing instrument.
- Seal 2 is compressed axially by piston 3. The seal expands radially and seals between connector and test piece.
- The pressure testing medium, compressed air, vacuum or water is supplied via port 4 from a manually or automatically controlled valve.
- The pressure testing medium fills the test piece to the preset pressure.
- Pressure testing / tightness testing / leak detection may now proceed.
- When the test is completed, the test medium is evacuated.
- The compressed air is evacuated from port 1 and the seal repels the piston. The piston returns to its initial position.

b Ø Test piece connecting diameter	Max. testing pressure* at 4 bar pilot pressure		a Ø mm	c Ø mm	d Ø mm	e mm	f mm	g mm	h thread	i thread
	secured	not secured								
10-12 12-14 14-16	8	5	2,5	40,0	4,0	14,0	18,5	59,0	G 1/8"	G 1/8"
16-18 18-20 20-22	8	5	4,0	40,0	6,5	15,0	20,0	62,0	G 1/8"	G 1/8"
22-24 24-26 26-28	8	5	4,0	50,0	7,0	19,0	24,0	54,0	G 1/8"	G 1/8"
28-30 30-32 32-34	8	5	7,0	60,0	11,0	32,0	37,0	67,0	G 1/8"	G 1/8"
34-37 37-40 40-43	8	2	9,5	75,0	16,0	46,0	55,0	91,0	G 1/8"	G 1/4"
43-47 47-51 51-55	8	2	12,0	90,0	16,0	46,0	57,0	93,0	G 1/8"	G 1/2"
55-58 58-62 62-65	8	1	12,0	100,0	16,0	57,0	67,0	105,0	G 1/8"	G 1/2"
65-69 69-72 72-75	8	1	12,0	110,0	16,0	65,0	76,0	117,0	G 1/8"	G 1/2"

Our standard connectors are available in dimensions up to 82-85. Other dimensions, special design or special material are offered on request.

\*Depends on material and friction